



CRIO&ENG S.R.L.

Piazza San Marco, 1
20121 Milano
Tel. 02/290.14.281 - Fax 02/65.99.036
e-mail: crioeng@5pengineering.it

**TECHNICAL SPECIFICATION OF WATER VAPORIZER AT LOW PRESSURE
WITH PRESSURIZED SHELL SIDE**

CLIENT	JOB N°					SPECIFICATION N° 001-2000AR			
TYPE	1000	1500	2500	3500	5000	7500	10.000	20.000	
N2 FLOW RATE Nm3/h	1000	1500	2500	3500	5000	7500	10.000	20.000	
SURFACE m2	6	9	16	22	33	44	55	110	

Pos.	CONNECTIONS LIST AND OVERALL DIMENSIONS								
A	Liquid Inlet	ND 25	ND 25	ND 25	ND 40	ND 50	ND 50	ND 65	ND 80
B	Gas Outlet	ND 50	ND 65	ND 80	ND 125	ND 150	ND 150	ND 200	ND 250
C	Water Inlet	ND 80	ND 100	ND 100	ND 100	ND 125	ND 125	ND 150	ND 200
D	Water Outlet	ND 80	ND 100	ND 100	ND 100	ND 125	ND 125	ND 150	ND 200
E	Pressure builder inlet	ND 25	ND 25	ND 25	ND 25	ND 25	ND 25	ND 40	ND 40
F	Pressure builder outlet	ND 40	ND 40	ND 40	ND 40	ND 40	ND 40	ND 50	ND 80
G	Vessel Internal dia. mm	900	1100	1300	1500	2100	2100	2100	2500
H	Maximum Height mm	2342	2422	2600	5200	5200	5200	5500	5700
I	Nozzles Projection mm	2412	2422	2600	5100	5100	5100	5400	5600
L	Earth Distance mm	335	285	325	500	500	500	500	500

DESIGN DATA

DATA	SHELL SIDE	PROCESS SIDE
DESIGN PRESSURE bar	7	15
DESIGN TEMPERATURE °C	+10/50	-196 /+ 100
WORKING PRESSURE bar	4	15
WORKING TEMPERATURE °C	+ 20/40	-180/+20
FLUID CONTENT	WATER	NITROGEN / OXIGEN
CORROSION mm	0	0

**C&E CAN SUPPLY VAPORIZER HAVING STEAM - WATER FLUID INTO THE SHELL SIDE
FURTHERMORE THEY CAN BE EQUIPPED WITH THE PRESSURE BUILDER COIL ON REQUEST**

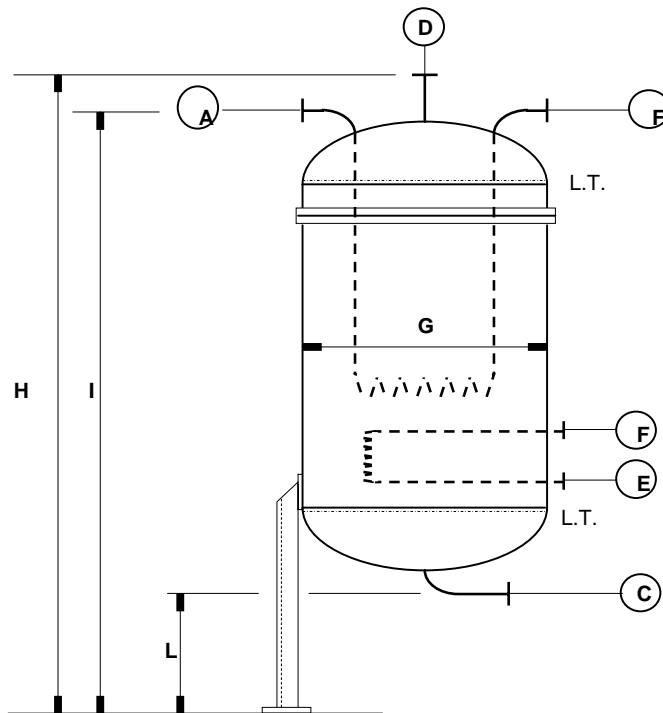

0				
REV.	DESCRIPTIONS	DRAF.	DATE	CHECK DATE